

*α*STEP

AZ Series

EtherCAT Drive Profile Compatible Driver

AZ Series drivers now include EtherCAT communications compatible with CiA 402 drive profile. For use with all Oriental Motor **AZ** Series motors and linear & rotary actuators equipped with the **AZ** Series.



AC Input



DC Input

EtherCAT®

EtherCAT Communications

The **AZ** series of motors can be easily added to an existing EtherCAT network.

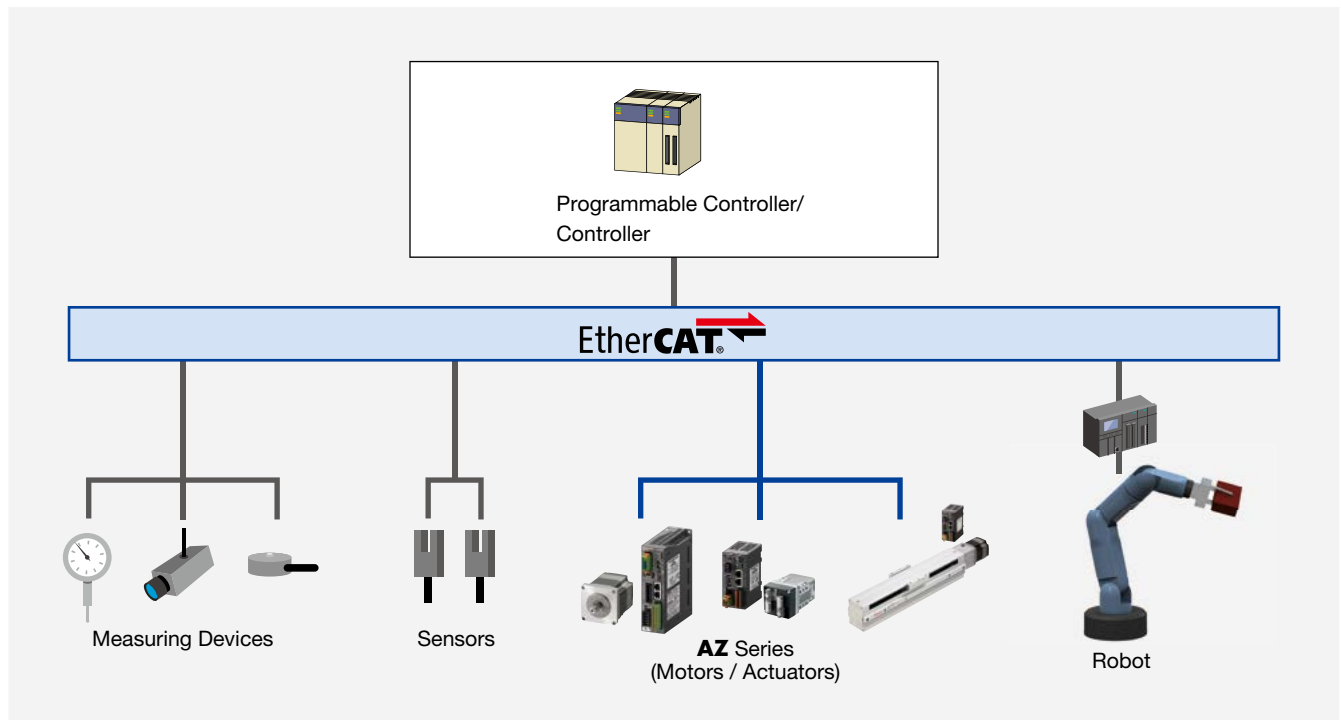

● **AZ** Series Catalog

Please see our separate catalog for the **AZ** Series products or visit our website.







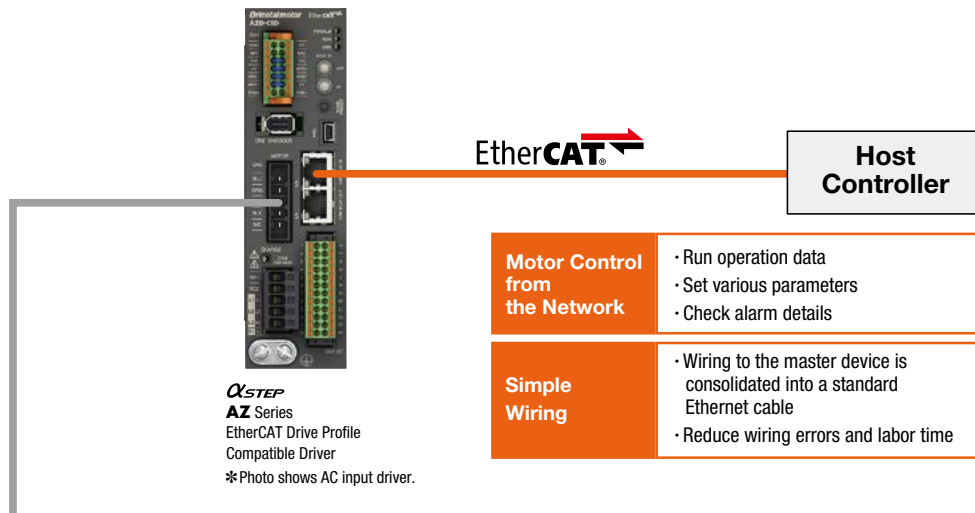



AZ Series Family of Motion Control with EtherCAT

Easily control the **AZ** Series by directly connecting to the EtherCAT master device using a standard Ethernet cable. This allows for quick and simple wiring.



AZ Series Motors and Linear & Rotary Actuators
 ● The Products shown below are representative examples.

AC Input / DC Input			
 AZ Series	 Hollow Rotary Actuators DGI Series Equipped with AZ Series	 Electric Linear Slides EAS Series Equipped with AZ Series	 Electric Cylinders EAC Series Equipped with AZ Series
AC Input Only	DC Input Only		
 Rack and Pinion Systems L Series Equipped with AZ Series	 Compact Electric Cylinders DR Series	 Compact Electric Cylinders DRS2 Series	 Electric Gripper EH Series

● **ESI File**

An ESI file has been prepared to allow EtherCAT compatible products to be used more easily. The ESI file can be downloaded from the Oriental Motor website.

AC Input

System Configuration

AZ Series with EtherCAT Drive Profile Compatible Driver

Motor, driver, and a connection cable set/flexible connection cable set are ordered separately.

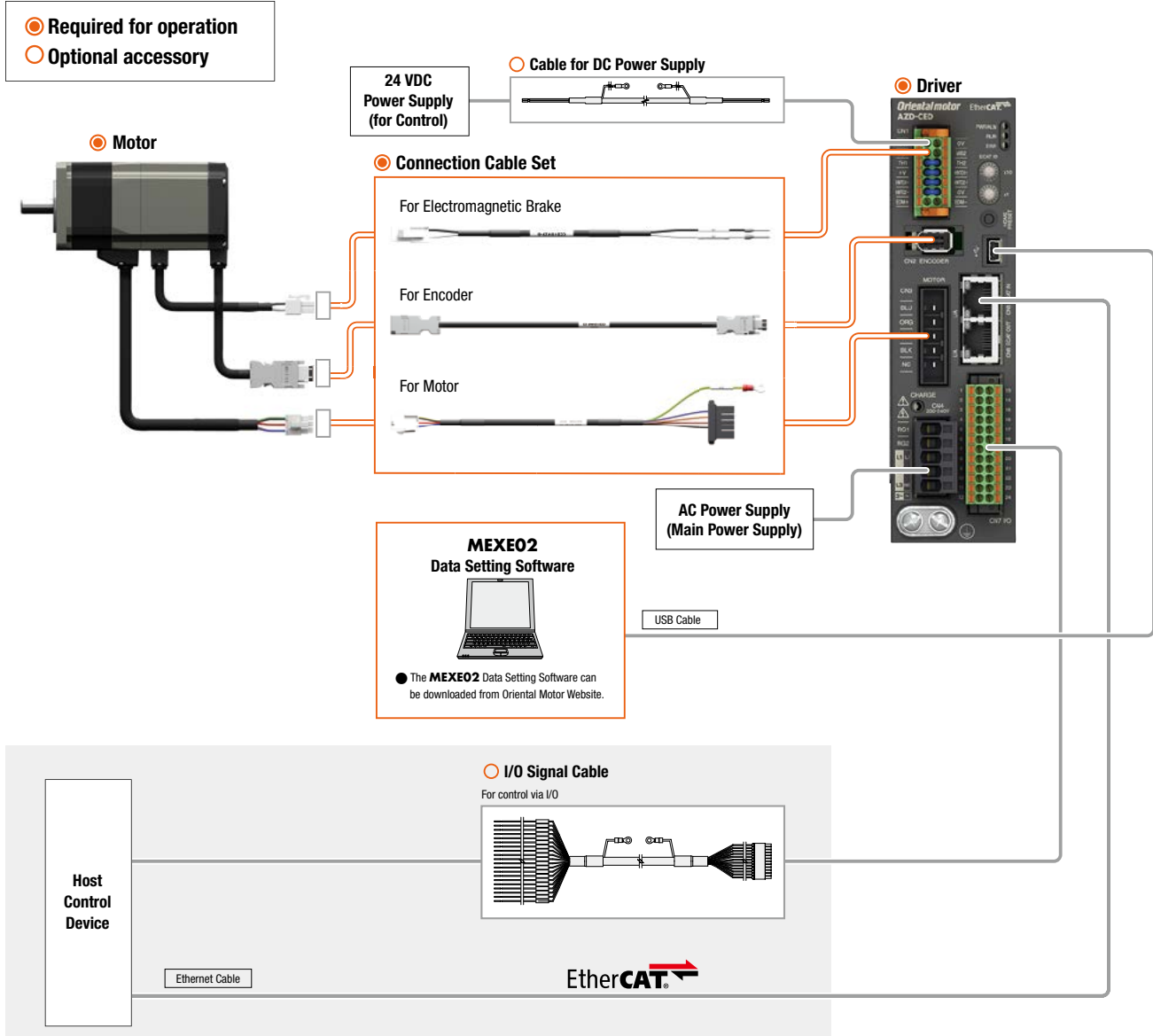

Notes

The motor cable and electromagnetic brake cable from the motor cannot be connected directly to the driver. When connecting to the driver, use a connection cable.

Product Name

AZD - C ED

①

②

③

①	Driver Type	AZD: AZ Series Driver
②	Power Supply Input	A: Single-Phase 100-120 VAC C: Single-Phase 200-240 VAC
③	Network Type	ED: EtherCAT Drive Profile

Product Line

Power Supply Input	Product Name	List Price
Single-Phase 100-120 VAC	AZD-AED	520.00 €
Single-Phase 200-240 VAC	AZD-CED	520.00 €

Included

Connector	Operating Manual
CN4 Connector (1 pc.) CN1 Connector (1 pc.) CN7 Connector (1 pc.) Connector Wiring Lever (1 pc.)	1 Copy

Specifications

Communications Specifications

Item	Description
Communications Standards	IEC 61158 Type12
Physical Layer/Protocol	100 BASE-TX (IEEE 802.3)
Transmission Rate	100 Mbps
Communication Cycle	Free Run Mode: 1 ms or more SM2 Event Synchronization Mode: 1 ms or more DC Mode: 0.25 ms, 0.5 ms, 1 ms, 2 ms, 3 ms, 4 ms, 5 ms, 6 ms, 7 ms, 8 ms
Communication Port/Connector	RJ45×2 (Shielded) ECAT IN: EtherCAT Input ECAT OUT: EtherCAT Output
Topology	Daisy Chain (Up to 65,535 Nodes)
Process Data	Variable PDO Mapping
Sync Manager	SM0: Mailbox Output SM1: Mailbox Input SM2: Process Data Output SM3: Process Data Input
Mailbox (CoE)	Emergency Message SDO Request SDO Response SDO Information
Synchronization Mode	Free Run Mode (Asynchronous) SM2 Event Synchronization Mode DC Mode (SYNCO Event Synchronization)
Device Profile	IEC 61800-7 CIA402 Drive Profile



Driver Specifications

Driver Product Name	AZD-AED	AZD-CED
Input Voltage	Single-Phase 100-120 VAC -15 to +6% 50/60 Hz	Single-Phase 200-240 VAC -15 to +6% 50/60 Hz
Main Power Supply	AZM46: 2.7 A, AZM48: 2.7 A, AZM66: 3.8 A AZM69: 5.4 A, AZM98: 5.5 A, AZM911: 6.4 A DGB85: 2.7 A, DGM85: 2.7 A, DGM130: 3.8 A DGM200: 6.4 A LM2: 3.8 A, LM4: 3.8 A	AZM46: 1.7 A, AZM48: 1.6 A, AZM66: 2.3 A AZM69: 3.3 A, AZM98: 3.3 A, AZM911: 3.9 A DGB85: 1.7 A, DGM85: 1.7 A, DGM130: 2.3 A DGM200: 3.9 A LM2: 2.3 A, LM4: 2.3 A
Control Power Supply	Input Voltage	24 VDC $\pm 5\%$ ^{*2}
	Input Current	0.25 A (0.5 A) ^{*3}
Interface	Pulse Input	2 inputs, Photocoupler Maximum input pulse frequency Line Driver: 1 MHz (50% duty) Open Collector: 250 kHz (50% duty)
	Control Input	6 inputs, Photocoupler
	Pulse Output	2 outputs, Line driver
	Control Output	6 outputs, Photocoupler/Open collector
	Power Shut Down Signal Input	2 inputs, Photocoupler
	Power Shut Down Monitor Output	1 output, Photocoupler/Open collector
	Field Network	EtherCAT

*1 Varies according to the motor it is combined with.

*2 If an electromagnetic brake motor is used, value is 24 VDC $\pm 4\%$ when the distance between the motor and driver is extended to 20 m using an Oriental Motor cable.

*3 The value inside the () represents the value for an electromagnetic brake motor. For the **AZM46** it is 0.33 A.

General Specifications

Degree of Protection	IP10
Operating Environment	Ambient Temperature: 0 to +55°C (non-freezing) ^{*1} Humidity: 85% or less (non-condensing) Altitude: Up to 1000 m above sea level Atmosphere: No corrosive gas or dust. The product should not be exposed directly to water, oil or other liquids.
Storage Conditions Shipping Conditions	Ambient Temperature: -25 to +70°C (non-freezing) Humidity: 85% or less (non-condensing) Altitude: Up to 3000 m above sea level Atmosphere: No corrosive gas or dust. The product should not be exposed directly to water, oil or other liquids.
Insulation Resistance	When a 500 VDC megger is applied to the following locations, resistance is 100 MΩ or higher. • Between the protective earth terminal and the main power supply terminal • Between the encoder connector and the main power supply terminal • Between the input signal terminal and the main power supply terminal
Dielectric Strength	No abnormalities are observed when the specified voltages are applied for 1 minute to the following locations. • Between the protective earth terminal and the main power supply terminal 1.5 kVAC 50/60 Hz • Between the encoder connector and the main power supply terminal 1.8 kVAC 50/60 Hz • Between the input signal terminal and the main power supply terminal 1.8 kVAC 50/60 Hz

*When a heat sink is installed that is equivalent to an aluminum plate with a size of at least 200×200 mm and 2 mm of thickness

Notes

- When measuring insulation resistance or testing dielectric strength, please disconnect the motor and driver.
- Also, do not perform these tests on the absolute sensor component of the motor.

Dimensions Unit: mm

Product Name	Mass [kg]
AZD-AED, AZD-CED	0.68

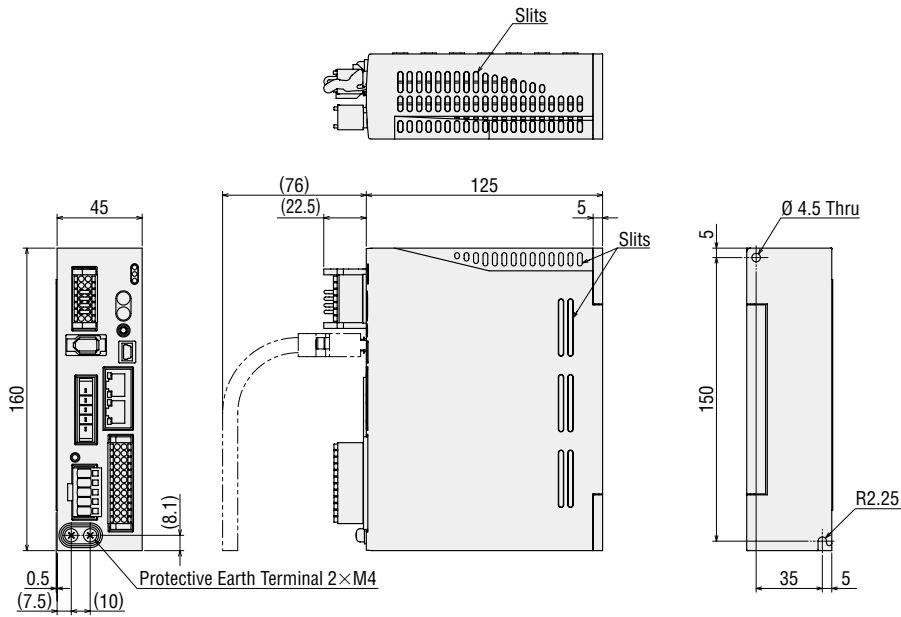

● Included

Main Power Supply/Connector for Regeneration Unit (CN4)
 Connector: 05JFAT-SAXGDK-H5.0 (J.S.T.)
 Connector Wiring Lever

24 VDC Power Supply Input/Electromagnetic Brake Connection/Regeneration Unit Thermal Input/Connector for Power Interruption Signal Input/Output (CN1)
 Connector: DFMC1_5/7-ST-3,5-LR (Phoenix Contact)

I/O Signal Connector (CN7)
 Connector: DFMC1_5/12-ST-3,5 (Phoenix Contact)

DC Input

System Configuration

AZ Series with EtherCAT Drive Profile Compatible Driver

Motor, driver, and a connection cable set/flexible connection cable set are ordered separately.

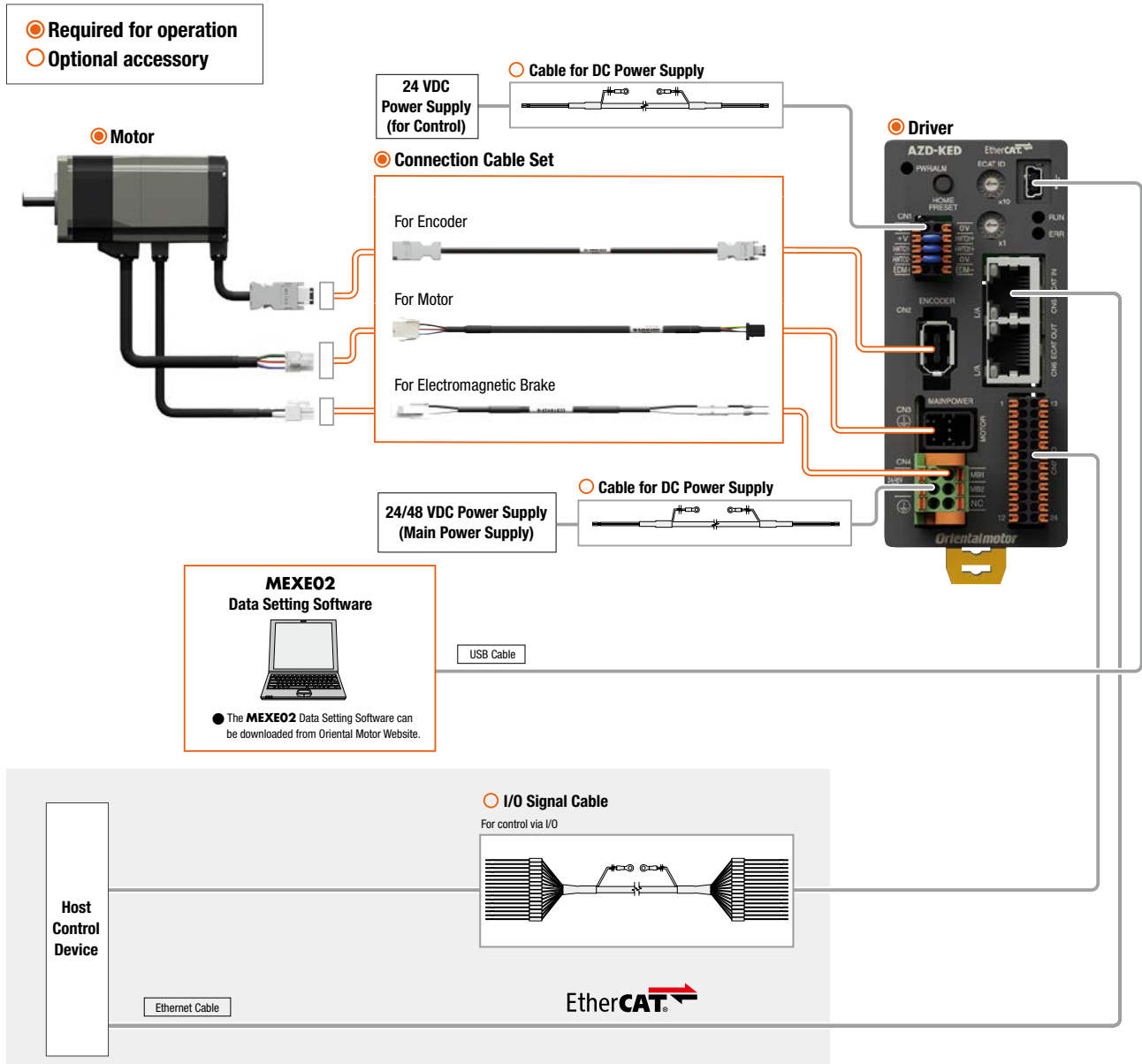

Notes

● The motor cable and electromagnetic brake cable from the motor cannot be connected directly to the driver. When connecting to a driver, use a connection cable.

Product Name

AZD - K ED

①

②

③

①	Driver Type	AZD: AZ Series Driver
②	Power Supply Input	K: 24/48 VDC
③	Network Type	ED: EtherCAT Drive Profile

Product Line

Power Supply Input	Product Name	List Price
24/48 VDC	AZD-KED	400.00 €

Included

Connector	Operating Manual
CN4 Connector (1 pc.) CN1 Connector (1 pc.) CN7 Connector (1 pc.)	1 Copy

Specifications

Communications Specifications

Item	Description
Communications Standards	IEC 61158 Type12
Physical Layer/Protocol	100 BASE-TX (IEEE 802.3)
Transmission Rate	100 Mbps
Communication Cycle	Free Run Mode: 1 ms or more SM2 Event Synchronization Mode: 1 ms or more DC Mode: 0.25 ms, 0.5 ms, 1 ms, 2 ms, 3 ms, 4 ms, 5 ms, 6 ms, 7 ms, 8 ms
Communication Port/Connector	RJ45×2 (Shielded) ECAT IN: EtherCAT Input ECAT OUT: EtherCAT Output
Topology	Daisy Chain (Up to 65,535 Nodes)
Process Data	Variable PDO Mapping
Sync Manager	SM0: Mailbox Output SM1: Mailbox Input SM2: Process Data Output SM3: Process Data Input
Mailbox (CoE)	Emergency Message SDO Request SDO Response SDO Information
Synchronization Mode	Free Run Mode (Asynchronous) SM2 Event Synchronization Mode DC Mode (SYNCO Event Synchronization)
Device Profile	IEC 61800-7 CIA402 Drive Profile

Driver Specifications



Driver Product Name	AZD-KED	
Main Power Supply	Input Voltage	24 VDC ±5% 48 VDC ±5%
	Input Current*1	AZM14: 0.4 A, AZM15: 0.5 A, AZM24: 1.6 A, AZM26: 1.5 A AZM46: 1.5 A, AZM48: 2.1 A, AZM66: 3.3 A, AZM69: 3.1 A DGM60: 1.6 A, DGB85: 1.5 A, DGM85: 1.5 A DGM130: 3.3 A, DR28: 1.3 A, DRSM42: 1.5 A EH4: 1.6 A
Control Power Supply	Input Voltage	24 VDC ±5%*2
	Input Current	0.15 A (0.4 A)*3
Interface	Pulse Input	2 inputs, Photocoupler Maximum input pulse frequency Line Driver: 1 MHz (50% duty) Open Collector: 250 kHz (50% duty)
	Control Input	6 inputs, Photocoupler
	Pulse Output	2 outputs, Line driver
	Control Output	6 outputs, Photocoupler/Open collector
	Power Shut Down Signal Input	2 inputs, Photocoupler
	Power Shut Down Monitor Output	1 output, Photocoupler/Open collector
	Field Network	EtherCAT

*1 Varies according to the motor it is combined with.

*2 If an electromagnetic brake motor is used, value is 24 VDC ± 4% when the distance between the motor and driver is extended to 20 m using an Oriental Motor cable.

*3 The value inside the () represents the value for an electromagnetic brake motor. For the **AZM46** it is 0.23 A.

General Specifications

Degree of Protection	IP10
Operating Environment	Ambient Temperature: 0 to +50°C (non-freezing) Humidity: 85% or less (non-condensing) Altitude: Up to 1000 m above sea level Atmosphere: No corrosive gas or dust. The product should not be exposed directly to water, oil or other liquids.
Storage Conditions Shipping Conditions	Ambient Temperature: -25 to +70°C (non-freezing) Humidity: 85% or less (non-condensing) Altitude: Up to 3000 m above sea level Atmosphere: No corrosive gas or dust. The product should not be exposed directly to water, oil or other liquids.
Insulation Resistance	When a 500 VDC megger is applied to the following locations, resistance is 100 MΩ or higher. - Between the protective earth terminal and the main power supply terminal

Notes

- When measuring insulation resistance or testing dielectric strength, please disconnect the motor and driver.
- Also, do not perform these tests on the absolute sensor component of the motor.

Dimensions Unit: mm

Product Name	Mass [kg]
AZD-KED	0.18

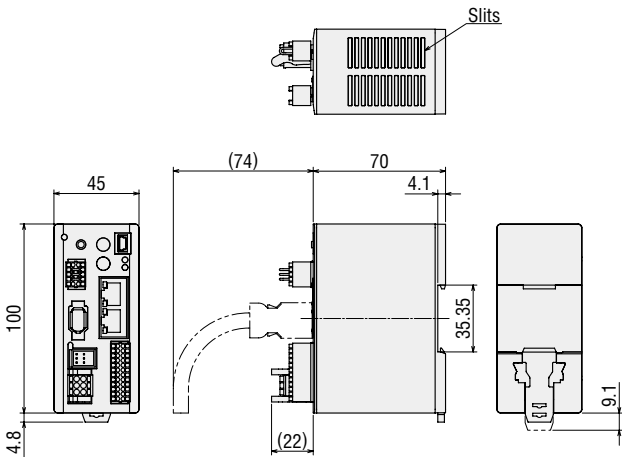

Included

Main Power Supply Connector (CN4)
Connector: DFMC1,5/3-ST-3,5-LR (Phoenix Contact)

Control Power Supply Connector (CN1)
Connector: DFMC0,5/5-ST-2,54 (Phoenix Contact)

I/O Signal Connector (CN7)
Connector: DFMC0,5/12-ST-2,54 (Phoenix Contact)

EtherCAT® is registered trademark and patented technology, licensed by Beckhoff Automation GmbH, Germany.

Orientalmotor

These products are manufactured at plants certified with the international standards **ISO 9001** (for quality assurance) and **ISO 14001** (for systems of environmental management).

Specifications are subject to change without notice. This catalogue was published in March 2020.

ORIENTAL MOTOR (EUROPA) GmbH

www.orientalmotor.de

European Headquarters

Schießstraße 44
40549 Düsseldorf, Germany
Tel: 0211-520 670 0 Fax: 0211-520 670 99

Spanish Office

C/Caléndula 93 - Ed. E - Miniparc III
28109 El Soto de La Moraleja,
Alcobendas (Madrid), Spain
Tel: +34 918 266 565
www.orientalmotor.es

ORIENTAL MOTOR (UK) LTD.

www.oriental-motor.co.uk

UK Headquarters

Unit 5, Faraday Office Park,
Rankine Road, Basingstoke,
Hampshire RG24 8AH, U.K.
Tel: 01256-347 090 Fax: 01256-347 099

ORIENTAL MOTOR SWITZERLAND AG

www.orientalmotor.ch

Switzerland Headquarters

Badenerstraße 13
5200 Brugg AG, Switzerland
Tel: 056-560 504 5 Fax: 056-560 504 7

ORIENTAL MOTOR ITALIA s.r.l.

www.orientalmotor.it

Italy Headquarters

Via XXV Aprile 5
20016 Pero (MI), Italy
Tel: 02-939 063 46 Fax: 02-939 063 48

ORIENTAL MOTOR (FRANCE) SARL

www.orientalmotor.fr

France Headquarters

56, Rue des Hautes Pâtures
92000 Nanterre, France
Tel: 01-478 697 50 Fax: 01-478 245 16



Other countries: www.orientalmotor.eu

Customer Service Center (Support in German & English)

00800-22 55 66 22*
CA LL OM CC

Mon-Thu: 08:00 - 17:30 CET Friday: 08:00 - 16:00 CET

* Free Call Europe

info@orientalmotor.de

For more information please contact: